

1st

feedback from
burl.crone@utoronto.ca (OSM)
2009 05 08

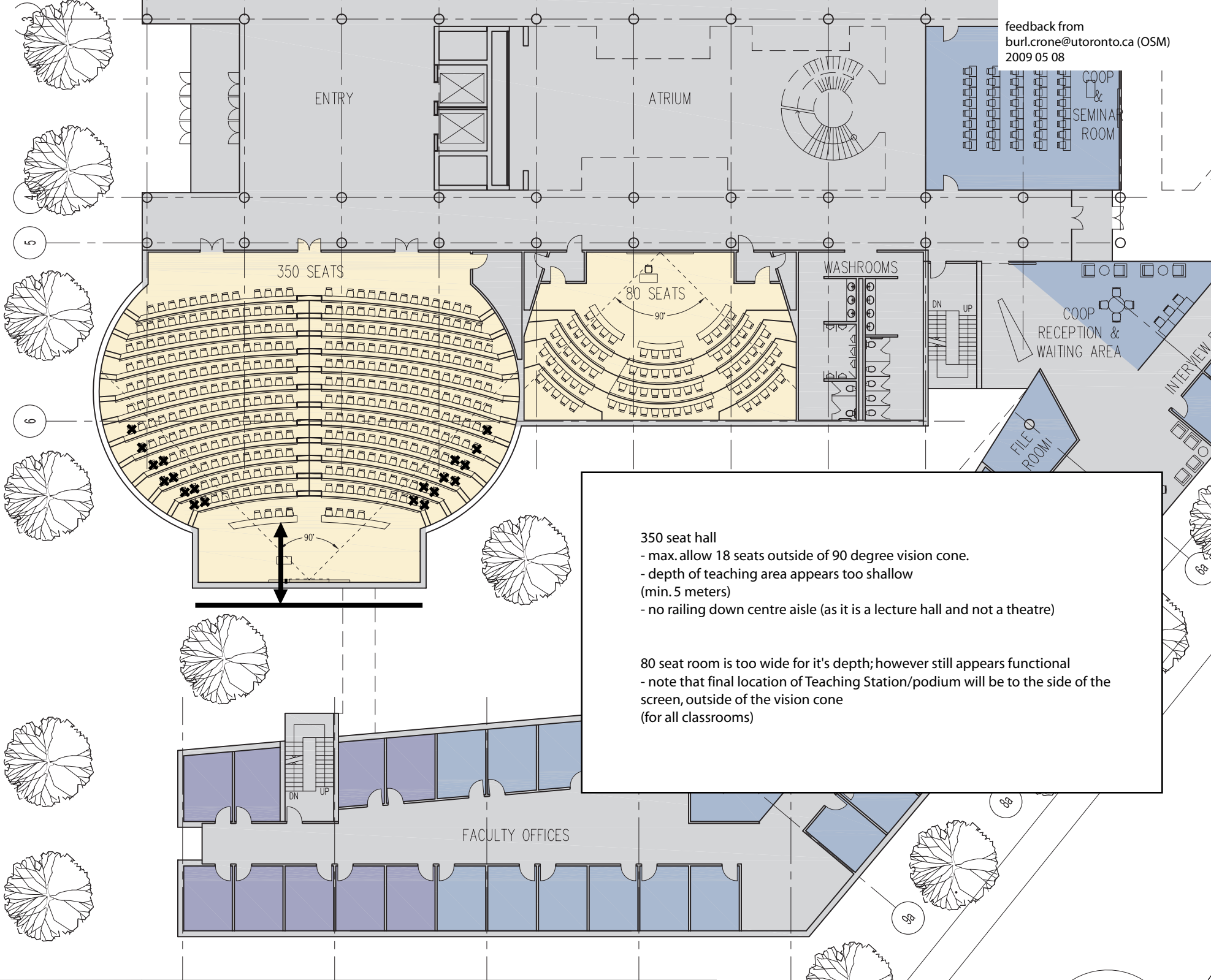

350 seat hall

- max. allow 18 seats outside of 90 degree vision cone.
- depth of teaching area appears too shallow (min. 5 meters)
- no railing down centre aisle (as it is a lecture hall and not a theatre)

80 seat room is too wide for it's depth; however still appears functional

- note that final location of Teaching Station/podium will be to the side of the screen, outside of the vision cone (for all classrooms)

- capacity 120 room squeezed into approx depth of 60 capacity room
 estimated 11m deep x 20m wide from this drawing - recommend max depth:width ratio 4:5, ex. 13x17m
 - this room is wider than MW170, capacity 120, which currently is getting complaints as being too wide for its depth.
 - column blocks screen . This screen would have to be mounted in front of column, giving less teaching area depth than the 60 capacity room (see final comments on 120 room spec sheet)

A L M

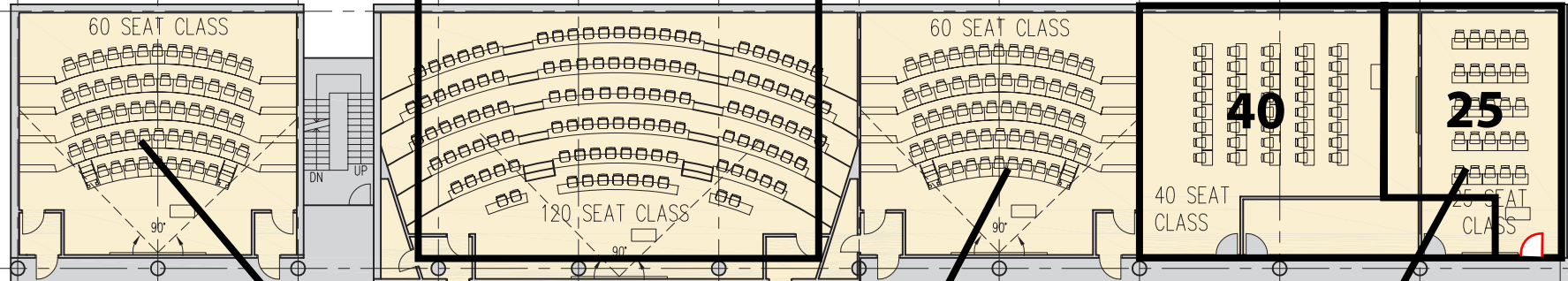

These 60 capacity rooms are fan style.
 Spec Sheets call for horseshoe / case style.

25 seat classroom too deep;
 suggest maximum width:depth ratio 3:4

If 120 capacity room were switched to this side, perhaps more depth could be added for it and for the 80 capacity room below

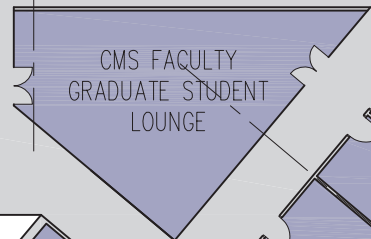
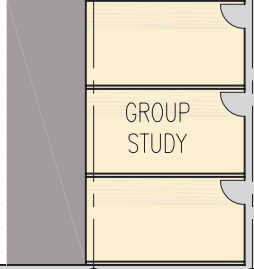

25 seat classroom too deep;
suggest maximum width:depth ratio 3:4

request all classrooms to have exterior windows

